



## Connect to Mercury Wi-Fi on an iPhone or iPad

**Mercury** is the secure wireless network at CUIMC. Using it requires a UNI login to register, and initial set up via a quick, automatic installation. See our website for a list of Mercury [locations on campus](#), FAQs and more.

NOTE: Instructions are for iPhones and iPads running iOS version 12 and up. Older versions may automatically install the profile and certificate without having to manually enter the device's Settings (steps 7 through 12), if so simply skip those steps and follow prompts that appear.

For all versions be sure you have downloaded and installed *both* the certificate (step 4) and profile (step 7).

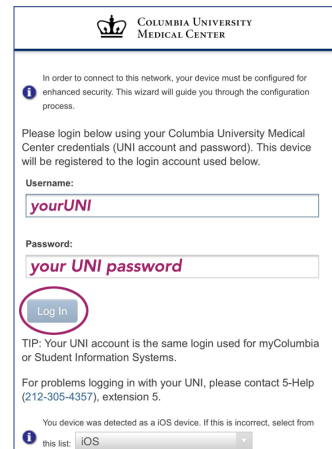
- To register, the device must either be:
  - Using any off-campus network connection with **CUIMC VPN**
  - On campus and connected to **guest-net** wireless
- Using the **Safari** browser go to: <https://it.cuimc.columbia.edu/mercury>  
NOTE: If you use another browser, files may save to a Downloads folder instead of automatically installing/appearing in Settings (step 7 and on).
- On the **Register Your Device** page enter your UNI and its password, then select **Log In**.  
TIP: Your UNI account is the same one used for Student Information Systems or myColumbia.
- On the next page, select **Install Certificate**.

- Tap **Allow** on the “This device is trying to download...” message that appears, then **Close** at the **Profile Downloaded** message.

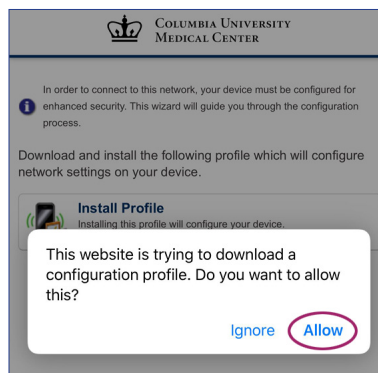

- Tap **Install Profile** at the next window, then **Allow** and **Close** on the messages that appear.
- Return to your device's home screen or list of apps and select **Settings**, then **General**.

Instructions continued on page 2

8. Tap **Profile** towards the bottom of the list.



9. Tap the **Device Enrollment - Columbia University Medical Center** link.

10. Tap **Install** in the upper right corner of the **Install Profile** window.

11. Tap **Install** two more times at the warning messages that appear.

12. The **Profile** window will show the **Device Enrollment** profile (and a link to **Remove Profile** at the bottom). Exit **Settings**.

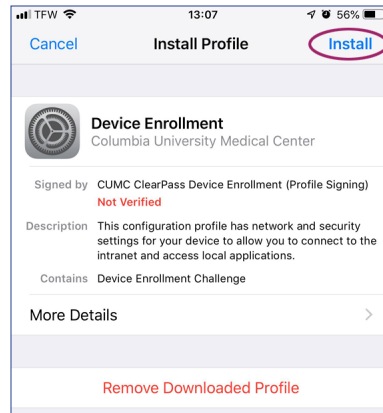

13. Safari will show a **Device provisioning complete** message indicating that registration and set up have successfully finished.

### Connect to Mercury

After successfully completing the register and set up steps above, the device should automatically connect whenever it is in range of the **mercury** wireless network. If not:

1. Enter your device's Wi-Fi settings: select **Settings** from the home screen or list of apps, then **Wi-Fi**.

2. Tap **mercury** from the list of wi-fi networks.

3. The device may take a moment to connect, and will show **mercury** as the Wi-Fi network it is using. Exit **Settings**.

TIP: If your device is automatically connecting to another wi-fi network but you'd like it to use Mercury, you can try removing the other network from the device's Wi-Fi list.

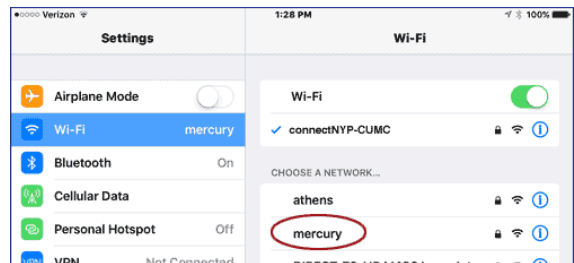

1. Open **Settings**, then **Wi-Fi** and select the name of the network you'd like to remove.

2. Select the link to **Forget this Network** and exit Settings.

To completely remove an installed wi-fi network's profile please see full instructions (including screenshots) to [Remove a Wireless Network on an iPhone or iPad](#).